

Assembly instructions  
BRANCH DINING TABLES

07652-XX-XX / 07654-XX-XX

Tribù nv  
Langendijkstraat 5a  
3690 Zutendaal  
BELGIUM

[www.tribu.com](http://www.tribu.com)  
[info@tribu.com](mailto:info@tribu.com)

**TRIBÙ**  
The art of leisure

## Content

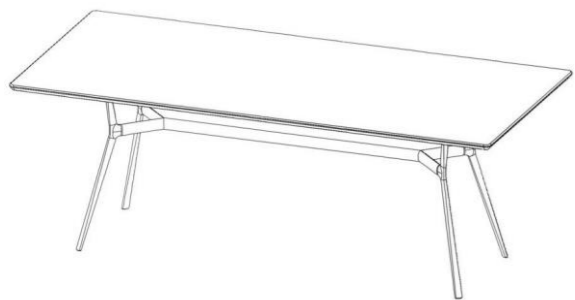

1 x Tabletop  
210x98cm or 300x110cm

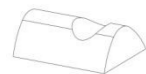

4 x T-nuttenstein



4 x bolt a (headless)



8 x bolt b (2cm)



4 x leg

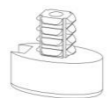

4 x glider

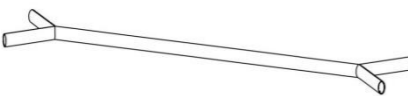

1 x connection

## Assembly Instructions

**1** Set the T-nuttenstein in place as in the picture below.

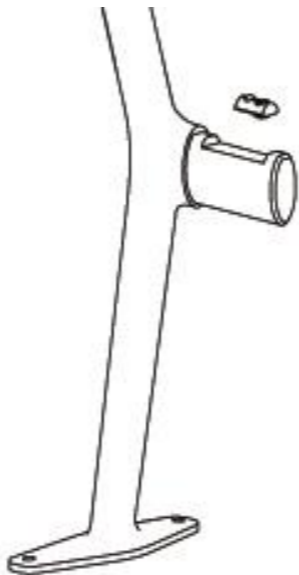

**3** Repeat step 1 and 2 for the other 3 legs.

**2** Slice the connector in place and screw with bolt a. DO NOT screw completely tight.

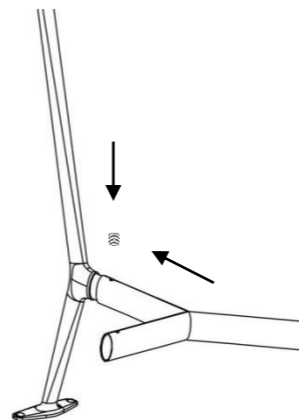

**4** Put the tabletop upside down onto another table and put the pre-assembled legs in place. WARNING : Put a cloth or foam in order to protect the tabletop from scratches.

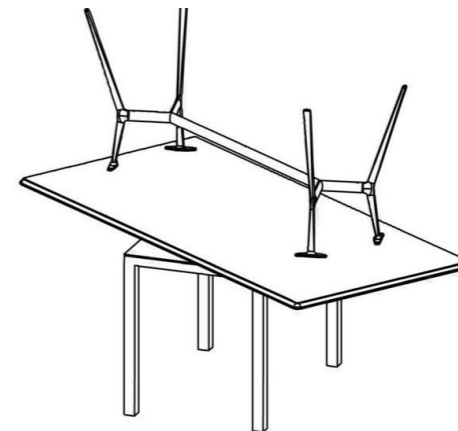

**6** While pushing the leg towards the center of the table, screw bolt a (see step 2) completely tight for each leg.

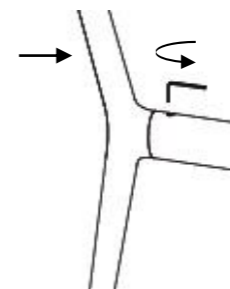

**5** Screw the legs in place with bolt b.

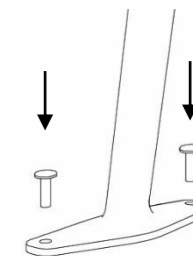

**7** Put the gliders in place.

